

Help pave the way for Hospice House

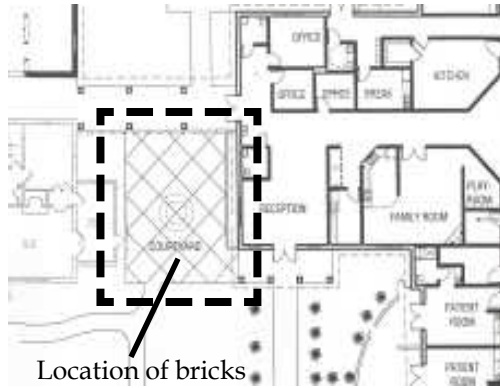

Engraving information:

- Three lines per brick paver / six lines per square brick.
- 21 characters per line (this includes spaces and punctuation).
- Please make sure your engraving information is spelled correctly.
- Upon your request, we will send a lovely card acknowledging the memorial or tribute gift.
- If you are sponsoring more than one brick, please make copies of this form or call us for additional forms.

*Thank you for supporting
Hospice Care of the Piedmont. For more
information, please call 864.227.9393.*

Non-Profit
U.S. Postage
PAID
Greenwood, SC
29649
Permit No. 472

HospiceCare of the Piedmont
408 West Alexander Avenue
Greenwood, SC 29646

The Courtyard
at Hospice House



Dedicate a brick...



